

NEW UTILITIES AROUND EXISTING WATER FACILITIES

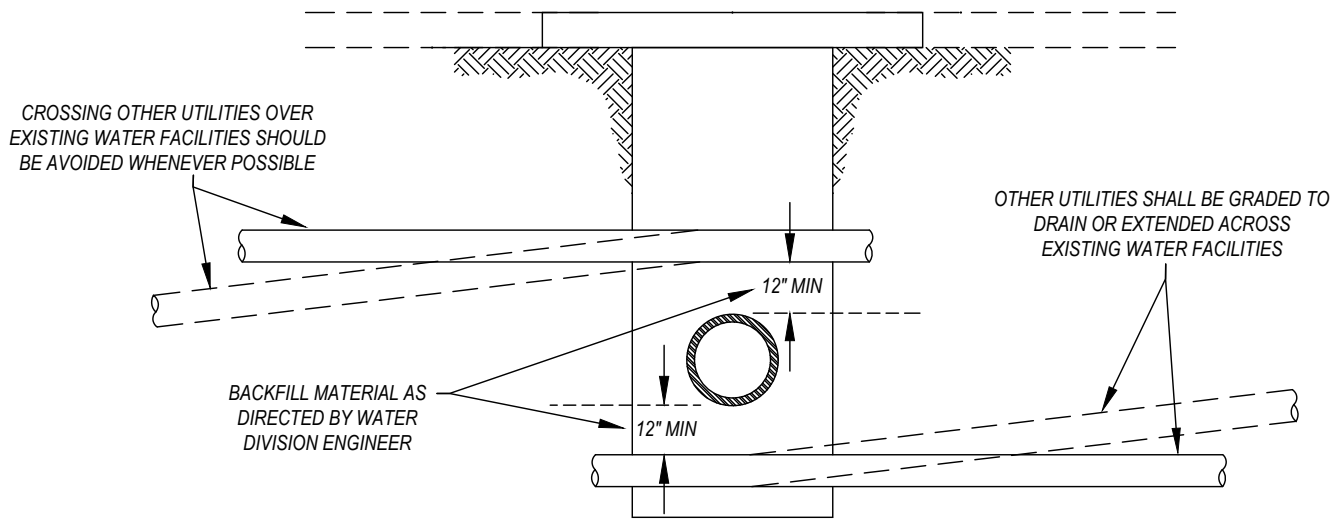

NEW WATER FACILITIES AROUND EXISTING UTILITIES

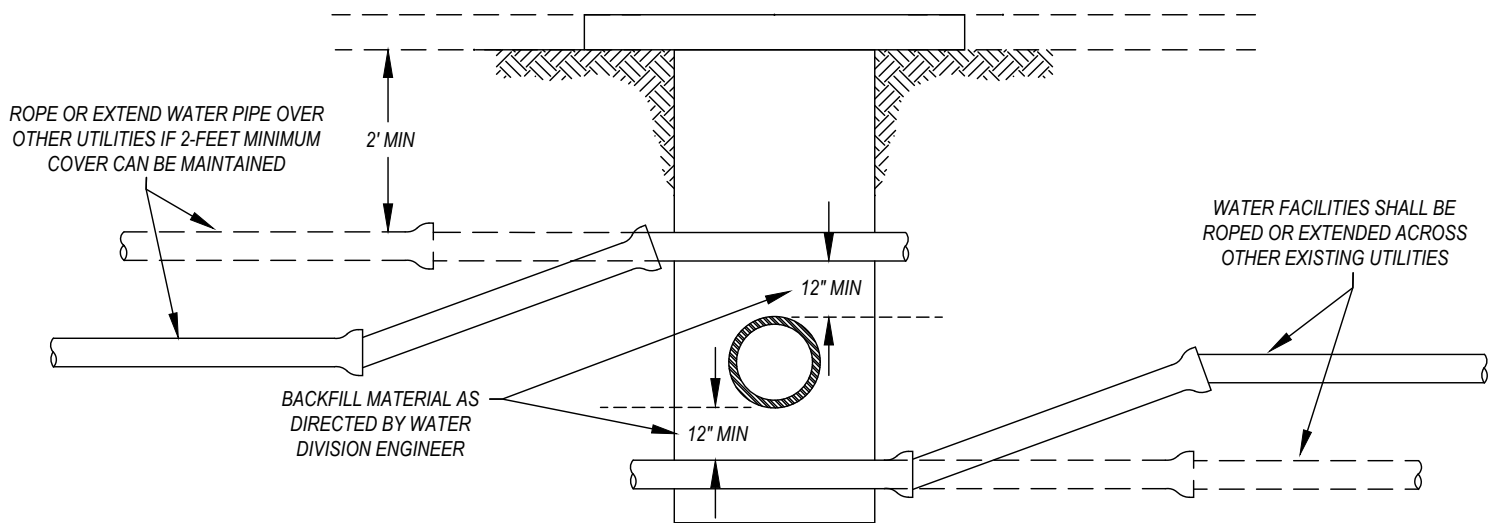

NOTES

1. WATER - SEWER, STORM, AND RECLAIMED WATER SEPARATION SHALL BE PER THE REQUIREMENTS OF THE STATE WATER RESOURCES CONTROL BOARD. WATER FACILITIES SHALL CROSS **OVER** SEWER, RECLAIMED WATER, STORM WATER ETC. FACILITIES WHENEVER POSSIBLE, OTHERWISE ADDITIONAL INSTALLATION REQUIREMENTS SUCH AS CLSM BACKFILL MAY BE REQUIRED OR AS DIRECTED BY THE WATER DIVISION ENGINEER.
2. IF EXISTING UTILITIES ARE REPLACED, THE NEW FACILITIES SHALL MEET THE CURRENT MINIMUM SEPARATION REQUIREMENTS.
3. IF THERE ARE DIFFERENT SEPARATION REQUIREMENTS BASED ON OTHER UTILITY, LOCAL, STATE, OR FEDERAL REGULATIONS OR REQUIREMENTS, THE STRICTER SEPARATION REQUIREMENTS SHALL PREVAIL.
4. WHEN UTILITIES CROSS OVER EXISTING WATER FACILITIES, BACKFILL OVER EXISTING WATER FACILITIES SHALL MEET THE WATER TRENCH DETAIL SPECIFICATIONS (SEE W-13A).
5. WHEN A MINIMUM 2-FOOT COVER (WITH 1- FOOT VERTICAL SEPARATION) CAN BE MAINTAINED OVER WATER FACILITIES, NEW WATER FACILITIES SHALL BE ROPED OVER OTHER UTILITIES.
6. VERTICAL SEPARATION REQUIREMENTS BETWEEN NEW AND EXISTING WATER FACILITIES (BOTH 8" OR LESS IN DIAMETER), CAN BE REDUCED TO A MINIMUM 6" OF SEPARATION.
7. FOR HORIZONTAL SEPARATION REQUIREMENTS, SEE W-22A.

CITY OF NAPA

UTILITIES DEPARTMENT

TITLE
**VERTICAL SEPARATION
 REQUIREMENTS BETWEEN PUBLIC
 WATER FACILITIES AND OTHER UTILITIES**

DRAWN BY: DF
 APPROVAL DATE: 09/2021
 SCALE: NTS
 REVISED DATE: 09/2021

CHECKED BY: SL
 APPROVED BY: DD
 DRAWING NO. W-22B