

STANDARD PLANS

FIRE

INTENTIONALLY LEFT BLANK

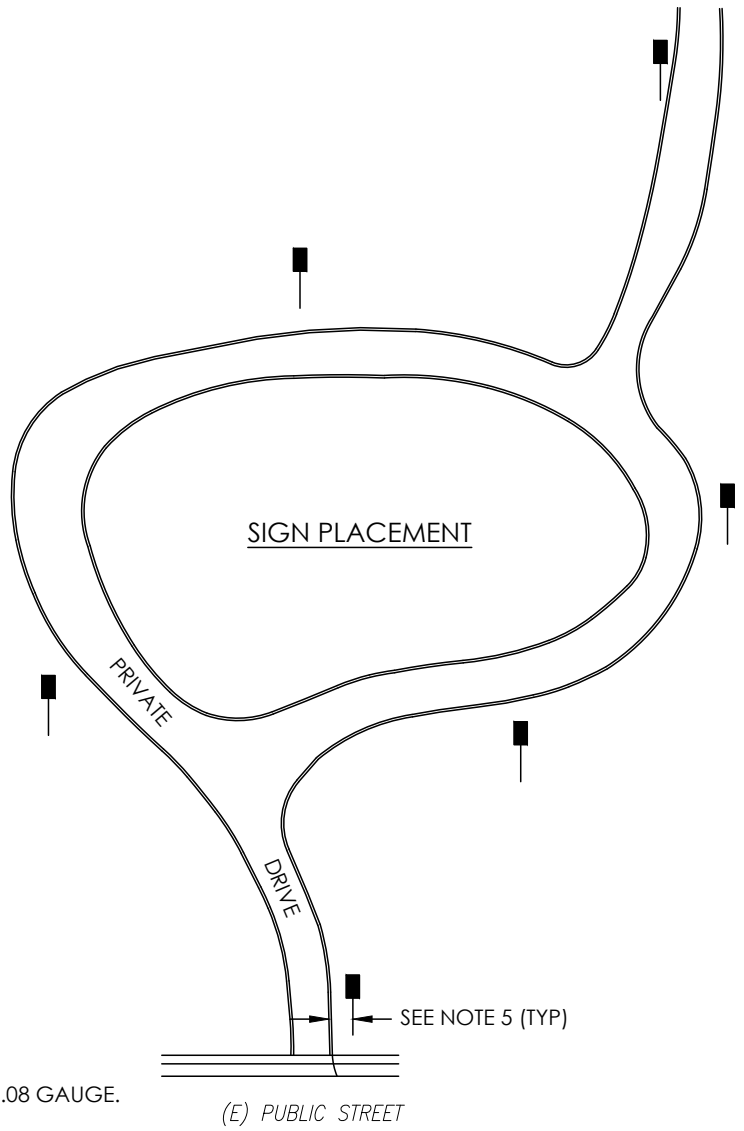

NOTES

1. SIGNS SHALL BE RED ON WHITE REFLECTIVE COMMERCIAL GRADE 0.08 GAUGE.
2. SIGNS SHALL BE VISIBLE AND READABLE ALONG ACCESS ROADWAY.
3. SIGNS ARE TO FACE ONCOMING TRAFFIC.
4. SIGNS ARE TO BE MAINTAINED BY THE PROPERTY OWNER.
5. A MINIMUM OF ONE SIGN SHALL BE POSTED AT THE BEGINNING AND END OF THE FIRE LANE AREA.
6. FOR CONTINUOUS FIRE LANES AREAS, SIGNS SHALL BE POSTED AT INTERVALS OF 100' MINIMUM AND 175' MAXIMUM.
7. SIGNS ARE TO BE POSTED SO THE BOTTOM OF THE SIGN IS 90" ABOVE GROUND LEVEL.
8. SIGN POSTS SHALL BE LOCATED 2' FROM EDGE OF TRAVELED WAY TO CENTER OF POST.
9. FINAL PLACEMENT OF ALL SIGNS SHALL BE SUBJECT TO THE APPROVAL OF THE FIRE CODE OFFICIAL.

CITY OF NAPA

FIRE DEPARTMENT

FIRE LANE SIGN & PLACEMENT

DRAWN BY:	LFM
APPROVAL DATE:	08/2021
SCALE:	NONE
REVISED DATE:	

CHECKED BY:	BV
APPROVED BY:	GDF
DRAWING NO.	FP-2

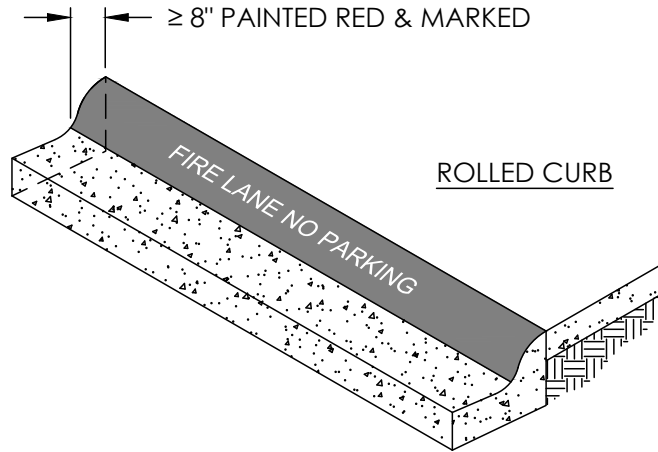

TOP & FACE PAINTED
RED & MARKED

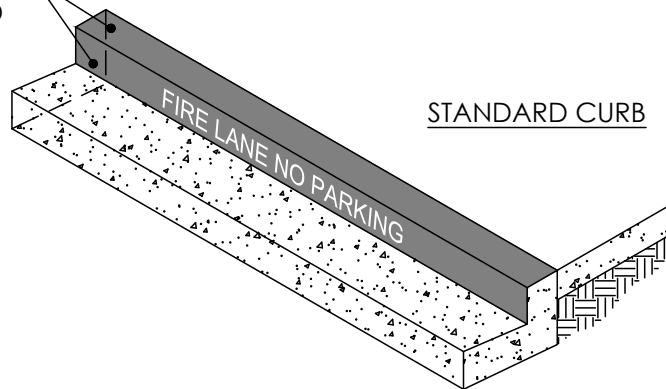

NOTES

1. ALL CURBS ALONG FIRE LANES ARE REQUIRED TO BE PAINTED RED AND STENCILED "FIRE LANE NO PARKING".
2. THERE SHALL BE A MAXIMUM DISTANCE OF 20' BETWEEN "FIRE LANE NO PARKING" LETTERING.
3. IF NO CURBS ARE PRESENT, CONTINUOUS RED STRIPING OF 6" WIDTH SHALL BE USED, LETTERING IS THE SAME AS CURBS.
4. LETTERING ON CURBS IS TO BE A MINIMUM OF 3" IN HEIGHT AND WHITE IN COLOR.

CITY OF NAPA

FIRE DEPARTMENT

FIRE LANE CURB PAINTING

DRAWN BY:	RC
APPROVAL DATE:	08/2021
SCALE:	NONE
REVISED DATE:	

CHECKED BY:	BV
APPROVED BY:	GDF
DRAWING NO.	FP-3

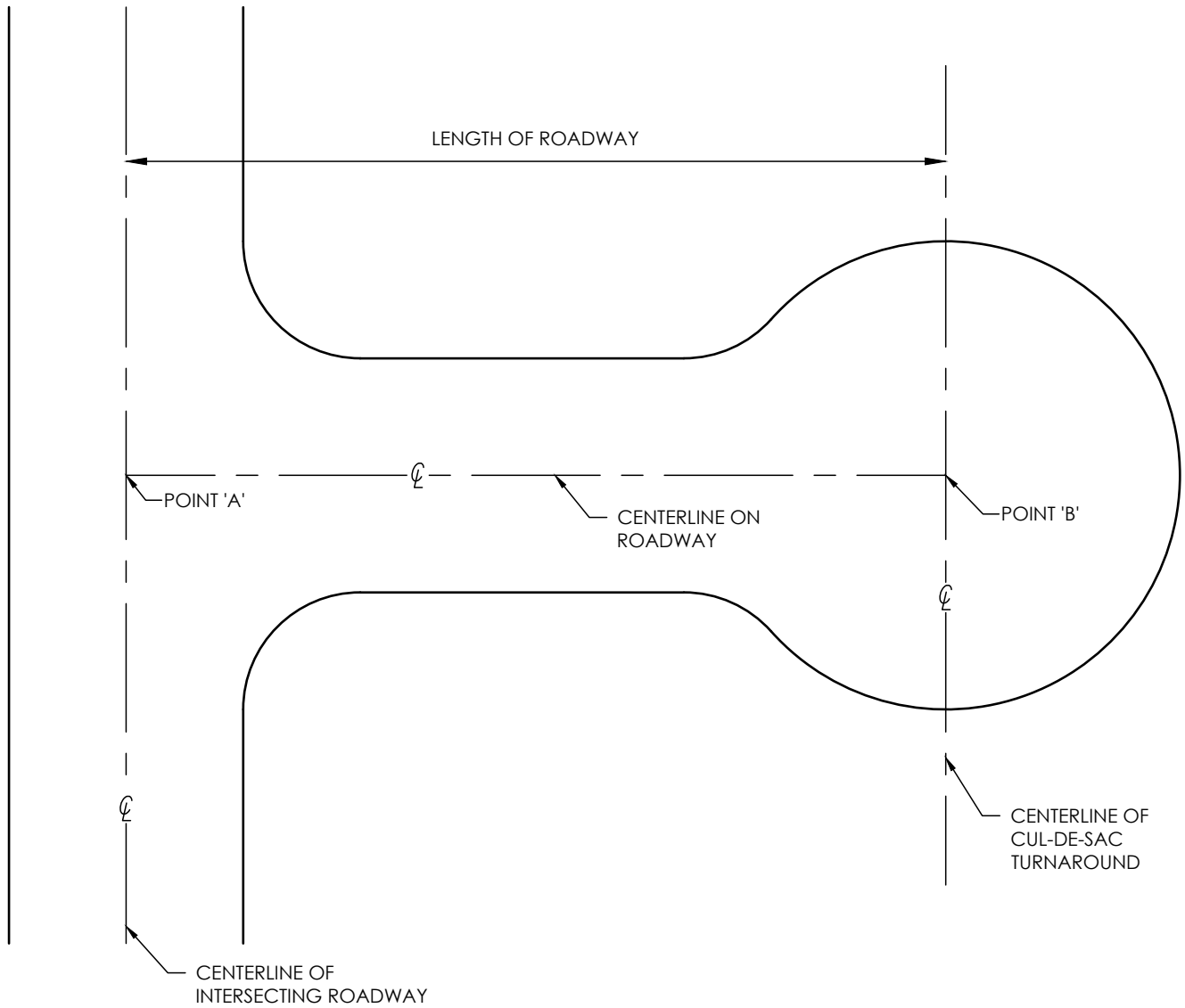

CITY OF NAPA

FIRE DEPARTMENT

METHOD OF MEASURING
CUL-DE-SAC-LENGTH

DRAWN BY:	RC
APPROVAL DATE:	08/2021
SCALE:	NONE
REVISED DATE:	

CHECKED BY:	BV
APPROVED BY:	GDF
DRAWING NO.	FP-4

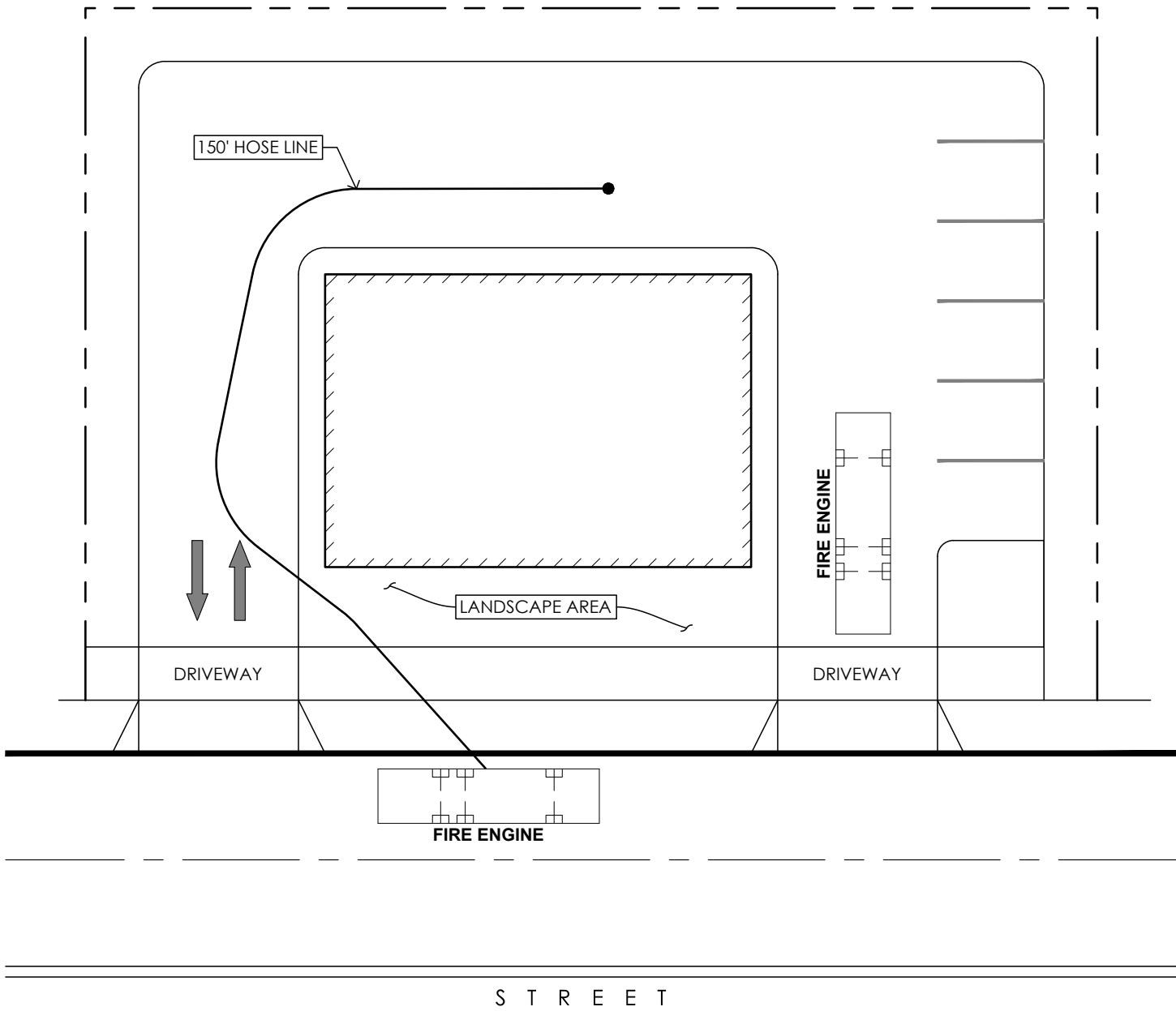

CITY OF NAPA

FIRE DEPARTMENT

ROUTE OF TRAVEL AROUND BUILDINGS

DRAWN BY:	RC	CHECKED BY:	BV
APPROVAL DATE:	08/2021	APPROVED BY:	GDF
SCALE:	NONE	DRAWING NO.	FP-5
REVISED DATE:			

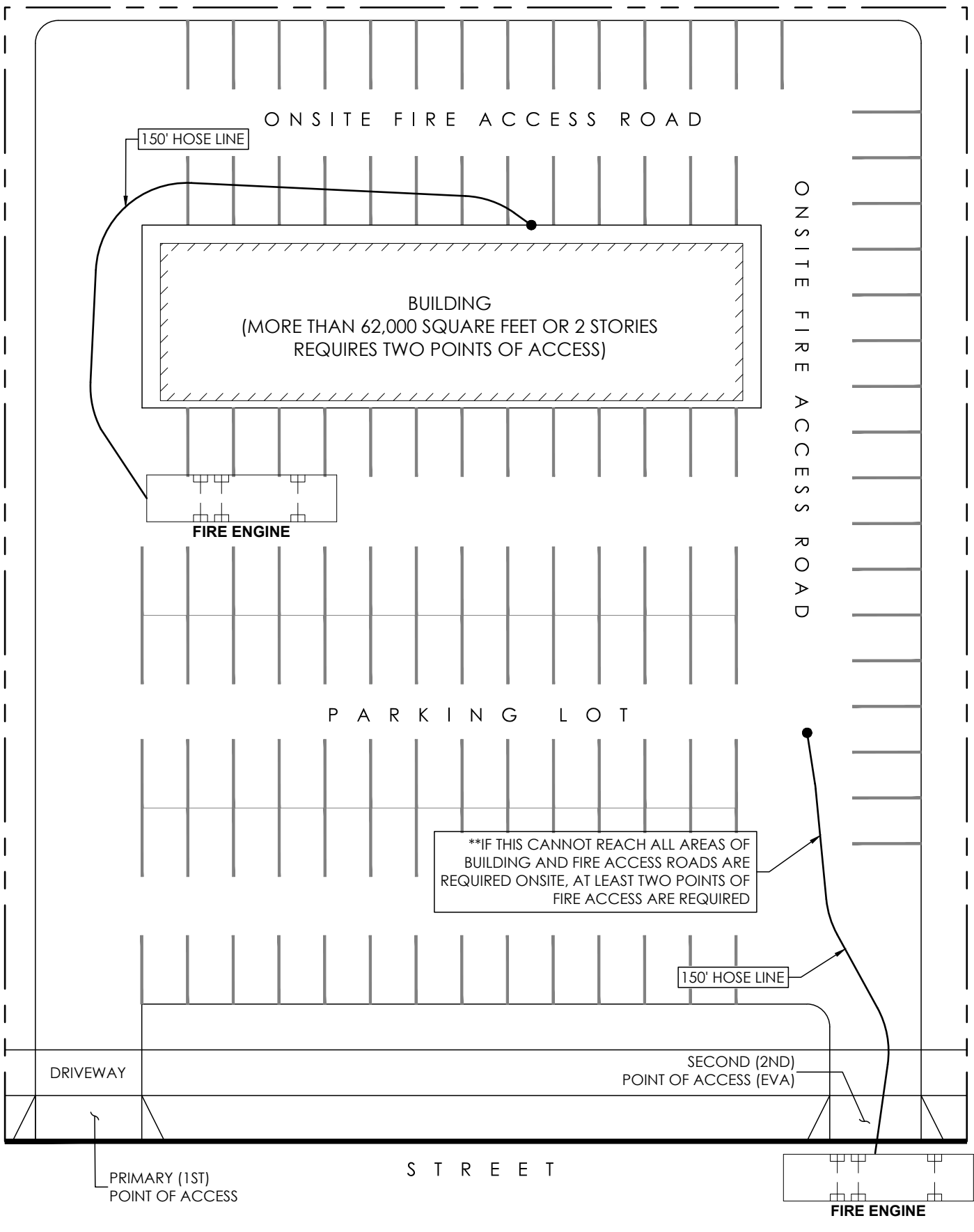

CITY OF NAPA

FIRE DEPARTMENT

MULTIPLE POINTS OF ACCESS

DRAWN BY: RC
 APPROVAL DATE: 08/2021
 SCALE: NONE
 REVISED DATE:

CHECKED BY: BV
 APPROVED BY: GDF
 DRAWING NO. FP-6

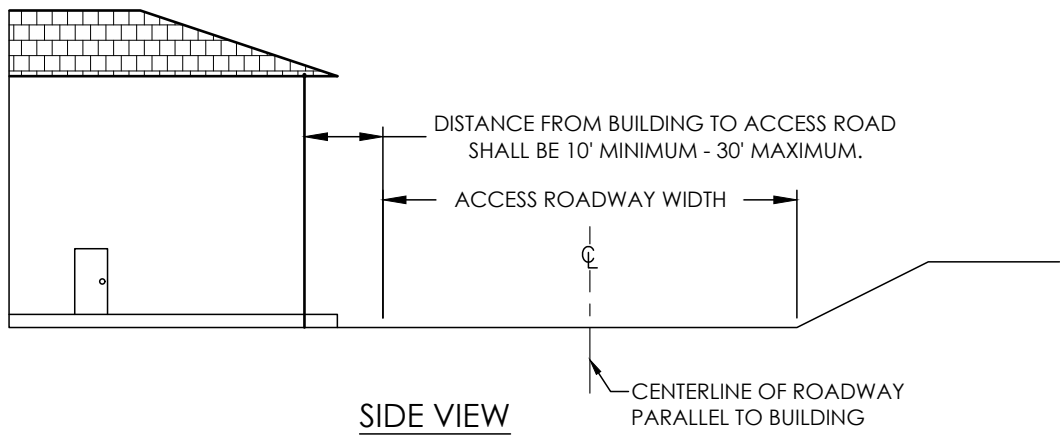
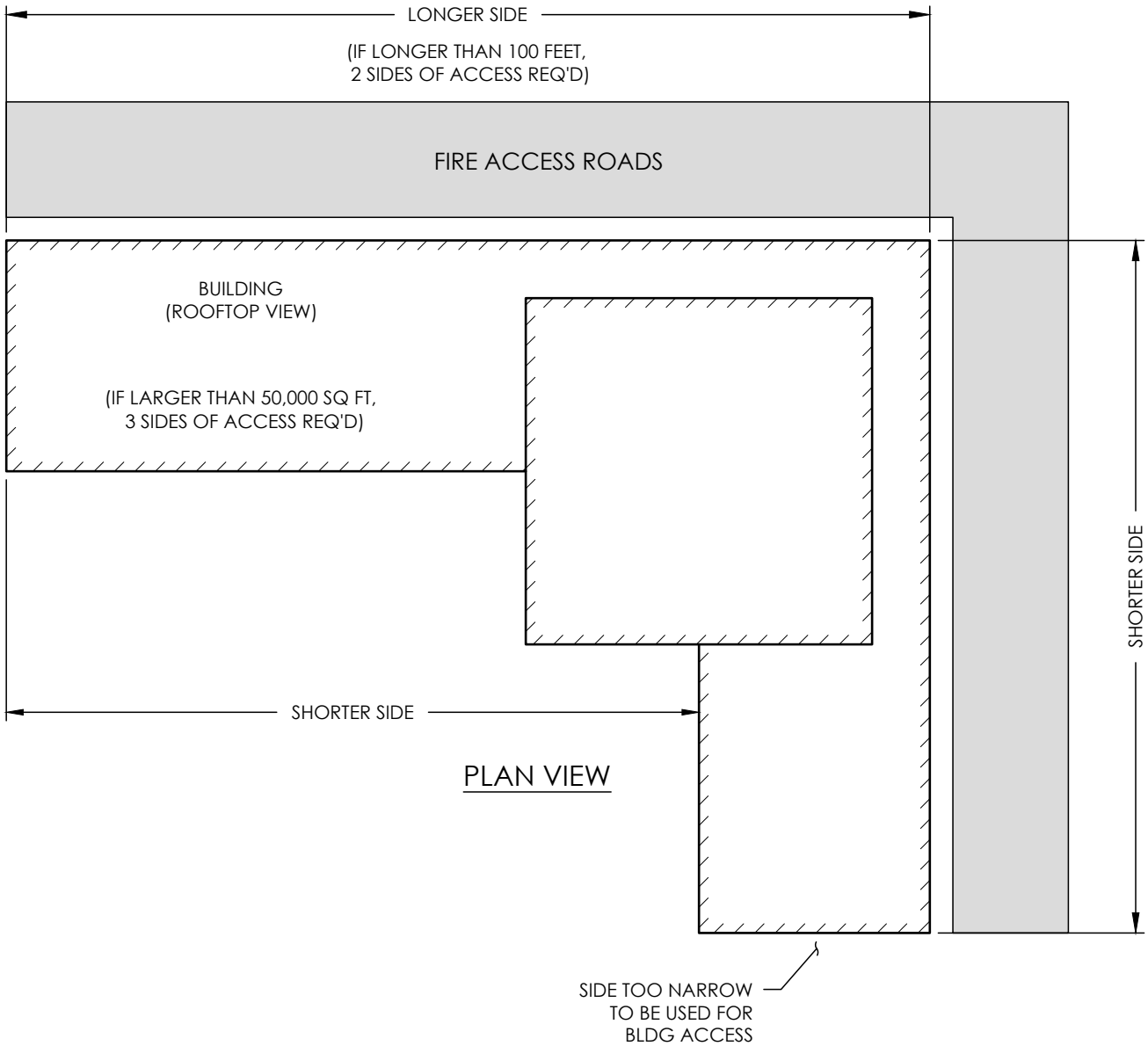

CITY OF NAPA

FIRE DEPARTMENT

SIDES OF BUILDING ACCESS

DRAWN BY: RC
 APPROVAL DATE: 08/2021
 SCALE: NONE
 REVISED DATE:

CHECKED BY: BV
 APPROVED BY: GDF
 DRAWING NO. FP-7

ACCESS TO SPRINKLER RISERS

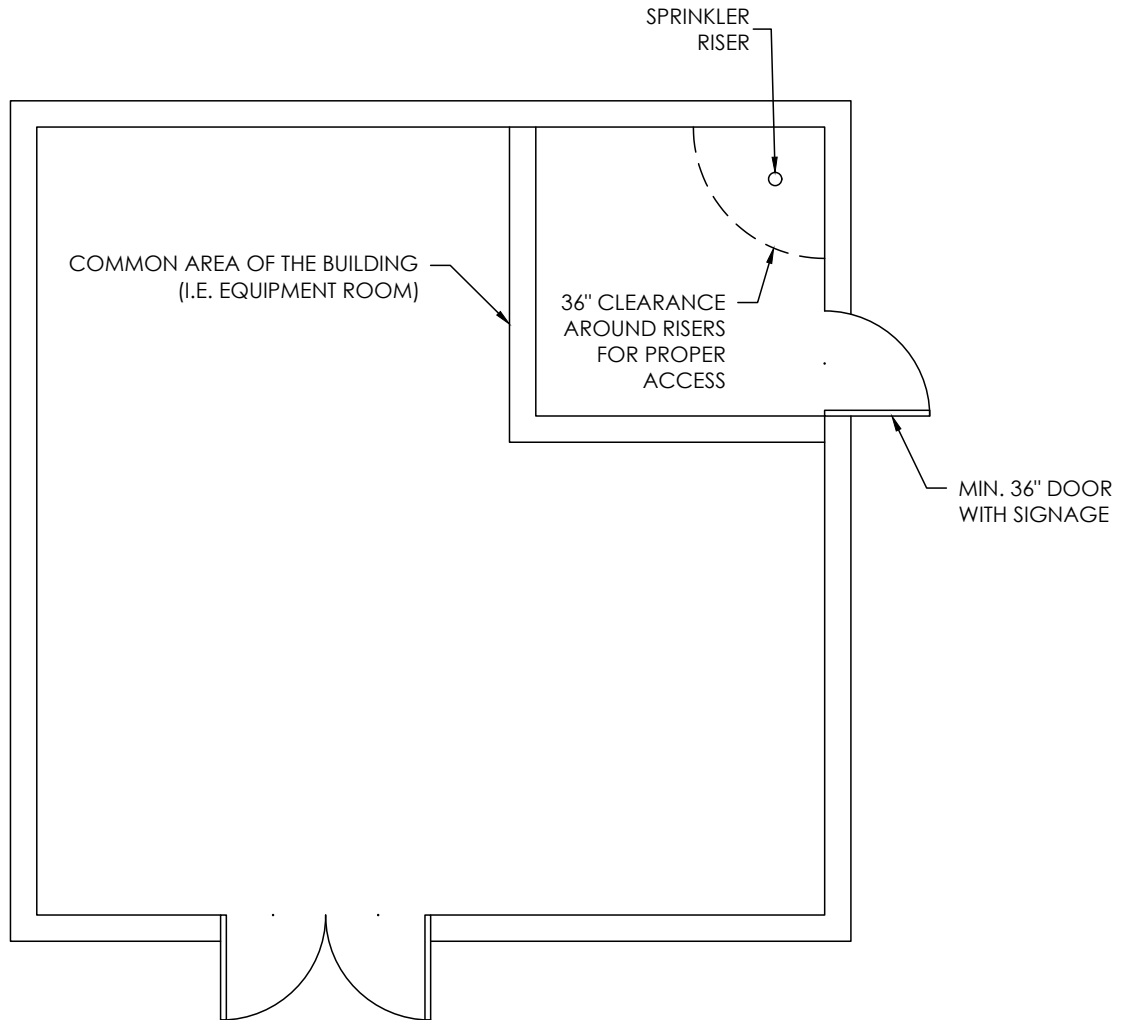

CITY OF NAPA

FIRE DEPARTMENT

FIRE SPRINKLER RISER ACCESS IN
MULTI-FAMILY OR COMMERCIAL BUILDINGS

DRAWN BY: RC
APPROVAL DATE: 08/2021
SCALE: NONE
REVISED DATE:

CHECKED BY: BV
APPROVED BY: GDF
DRAWING NO. FP-8

AUTOMATIC FIRE SPRINKLERS

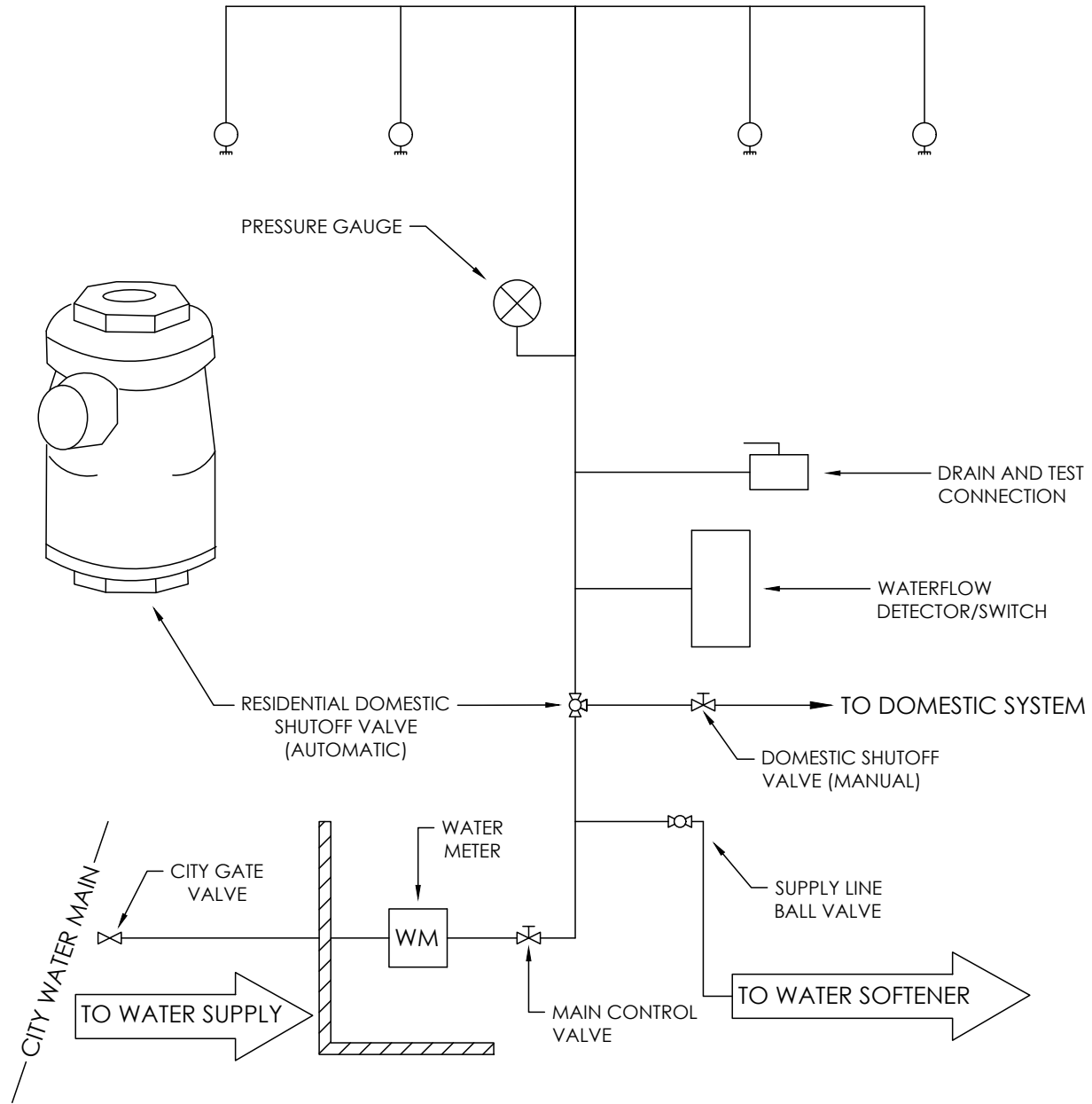

CITY OF NAPA

FIRE DEPARTMENT

DOMESTIC WATER SHUTOFF

DRAWN BY:	RC
APPROVAL DATE:	08/2021
SCALE:	NONE
REVISED DATE:	

CHECKED BY:	BV
APPROVED BY:	GDF
DRAWING NO.	FP-9

TOP VIEW

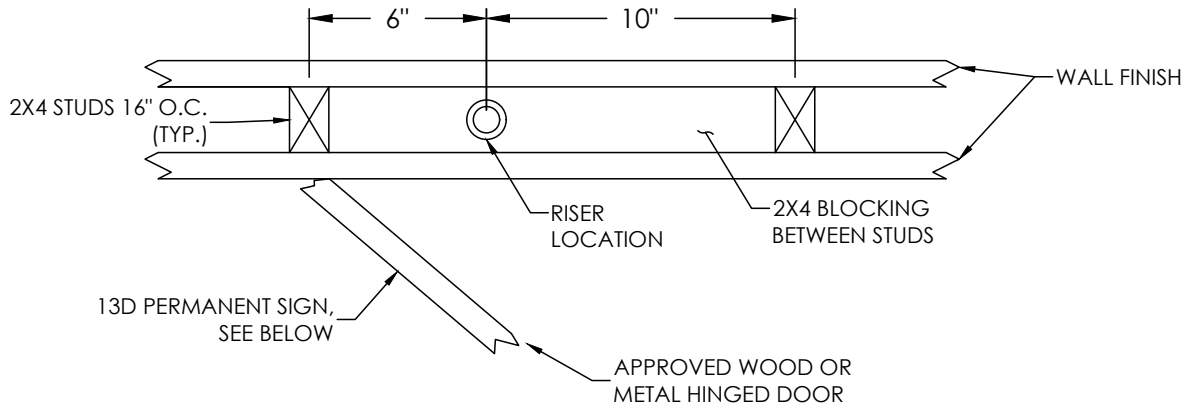

13D PERMANENT SIGN

"WARNING: THE WATER SYSTEM FOR THIS HOME SUPPLIES A SPRINKLER SYSTEM THAT DEPENDS ON CERTAIN FLOWS AND PRESSURES TO FIGHT A FIRE. DEVICES THAT RESTRICT THE FLOW OR PRESSURE SUCH AS PRESSURE REDUCERS AND WATER SOFTENERS SHALL NOT BE ADDED TO THE SYSTEM WITHOUT A REVIEW OF THE SYSTEM BY A FIRE PROTECTION SPECIALIST. LEAVE VALVE IN THE FULLY OPEN POSITIONS AT ALL TIMES."

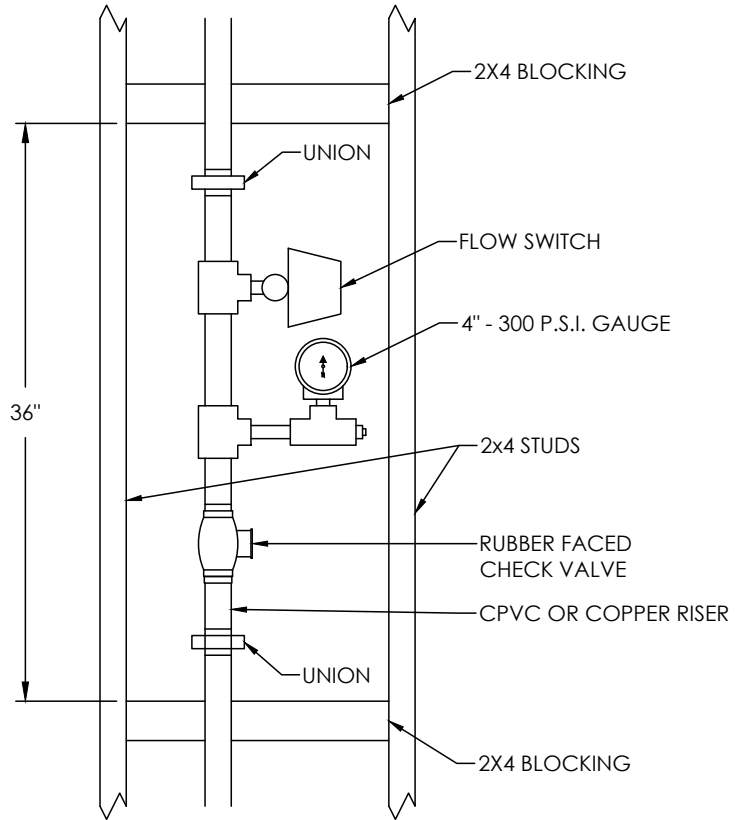

FRONT VIEW

SPRINKLER CABINET

STOCK OF SPARE SPRINKLERS

CITY OF NAPA

FIRE DEPARTMENT

RISER ACCESS PANEL DETAIL

DRAWN BY:	RC	CHECKED BY:	BV
APPROVAL DATE:	08/2021	APPROVED BY:	GDF
SCALE:	NONE	DRAWING NO.	FP-10
REVISED DATE:			

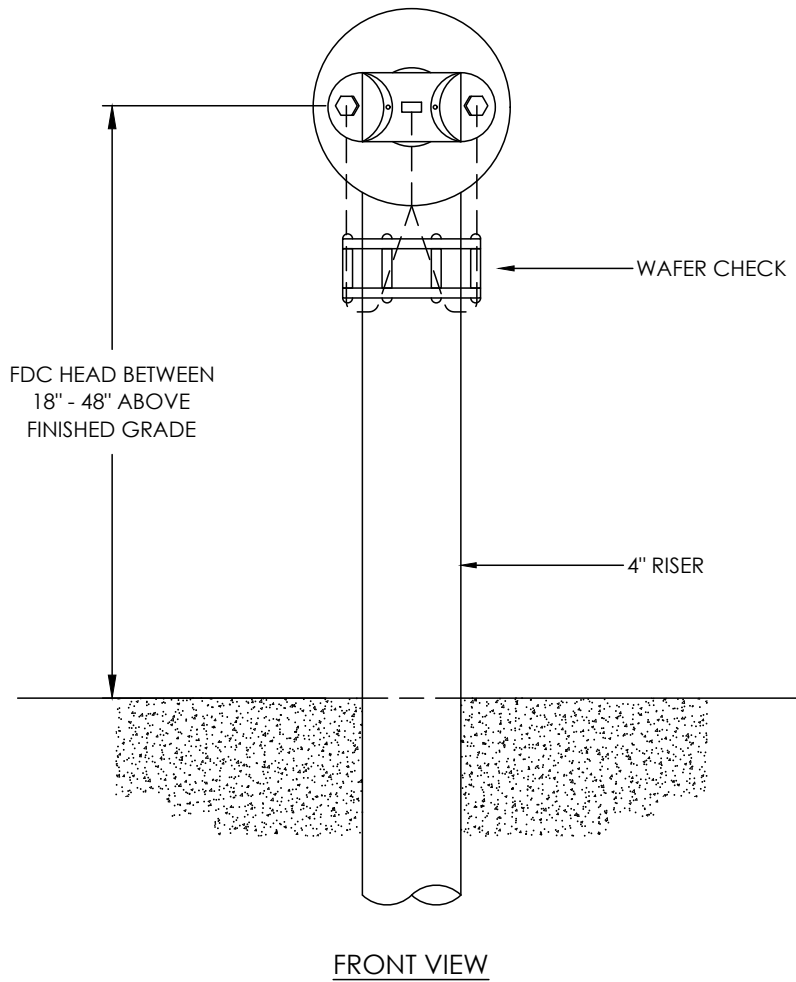
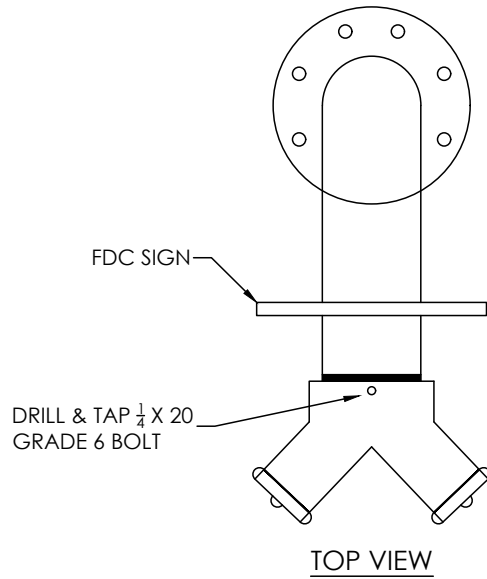

CITY OF NAPA

FIRE DEPARTMENT

SINGLE 4" X 2 $\frac{1}{2}$ " X 2 $\frac{1}{2}$ " FDC DETAIL

DRAWN BY:	RC
APPROVAL DATE:	08/2021
SCALE:	NONE
REVISED DATE:	

CHECKED BY:	BV
APPROVED BY:	GDF
DRAWING NO.	FP-11

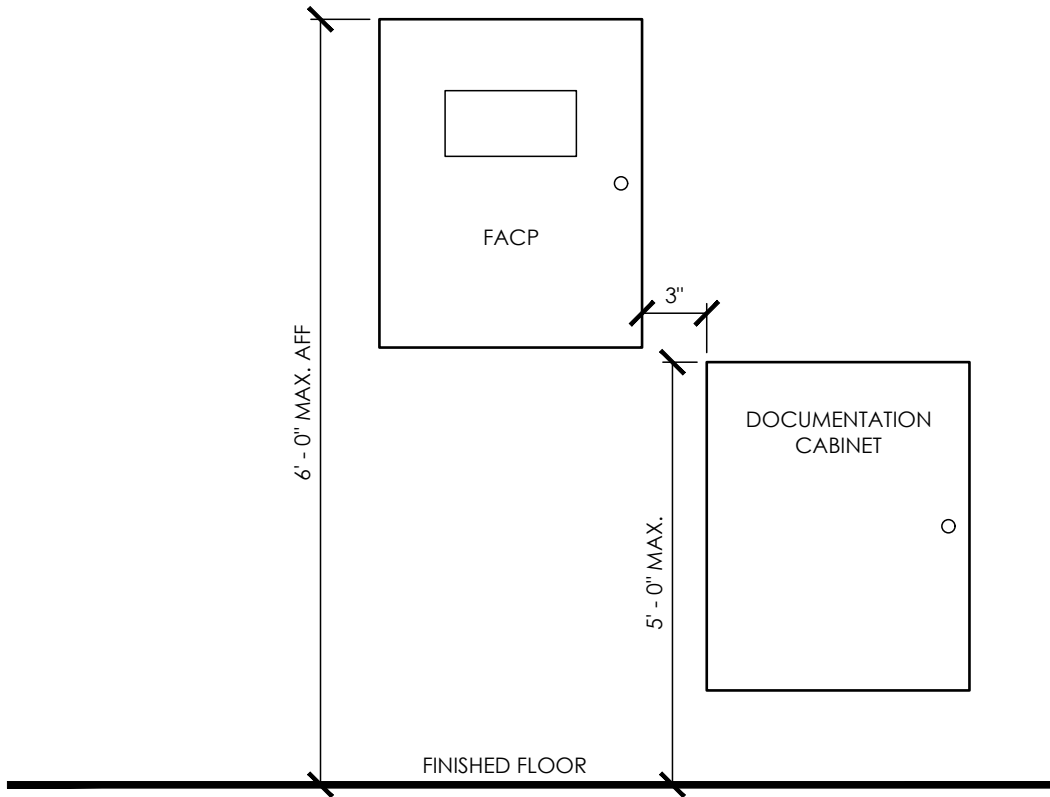

CITY OF NAPA

FIRE DEPARTMENT

FIRE ALARM CONTROL PANEL DETAILS

DRAWN BY:	RC
APPROVAL DATE:	08/2021
SCALE:	NONE
REVISED DATE:	

CHECKED BY:	BV
APPROVED BY:	GDF
DRAWING NO.	FP-12

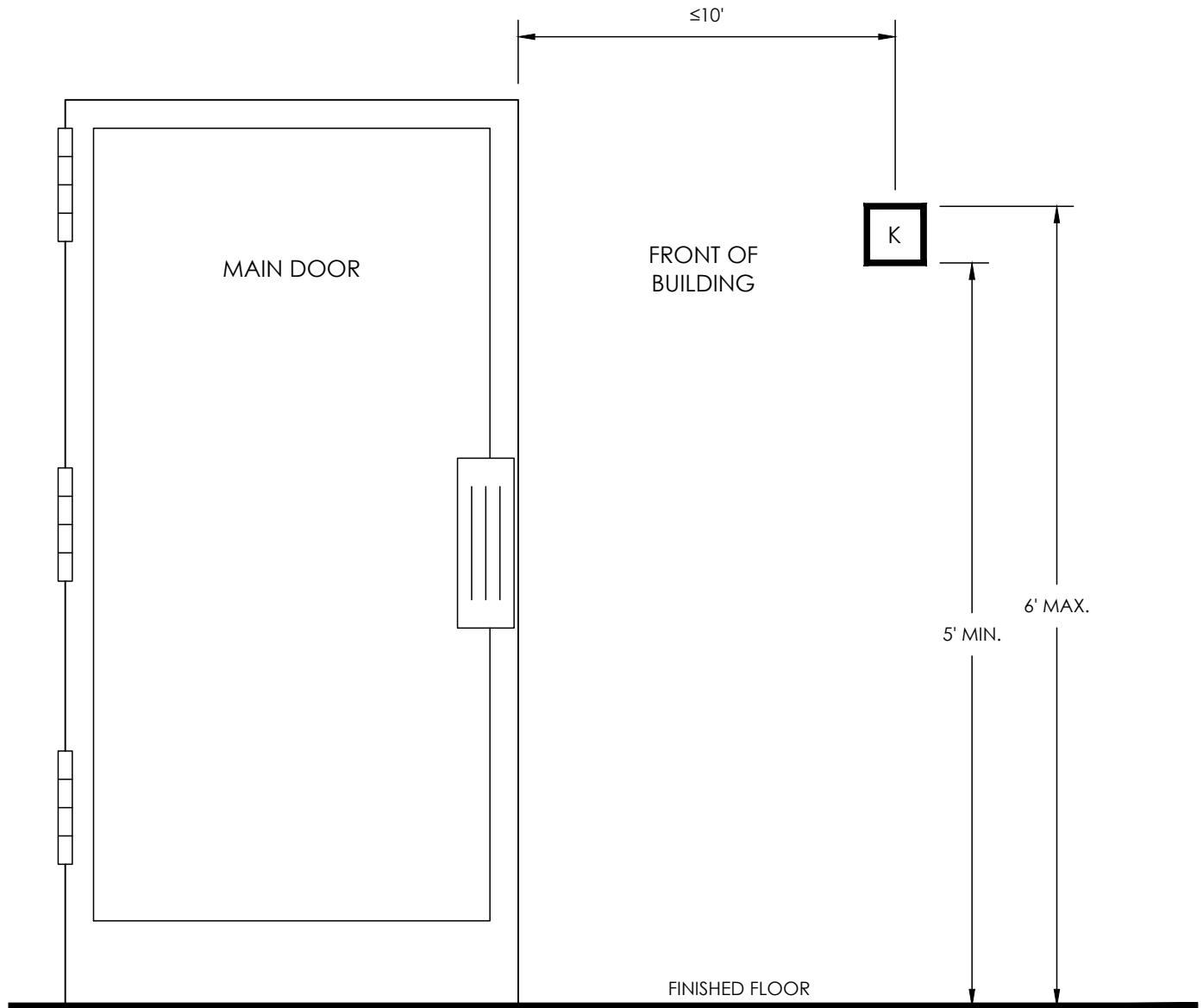

- NOTES:
- HAVE KEY(S) MADE THAT WILL PROVIDE ACCESS TO THE INTERIOR OF THE BUILDING, ANY INTERIOR SECURED AREAS AND ANY SPECIFIC KEYS REQUESTED BY THE FIRE DEPARTMENT.
 - THE KEY BOX SHALL BE INSTALLED NO LOWER THAN 5' FROM THE BOTTOM OF THE KEY BOX AND NO HIGHER THAN 6' FROM THE TOP OF THE KEY BOX ABOVE FINISHED GRADE. KEY BOX SHALL BE NO GREATER THAN 10' ADJACENT TO THE MAIN BUILDING ENTRANCE THAT FRONTS THE PUBLIC STREET ACCESS UNLESS DESIGNATED AT A DIFFERENT LOCATION BY THE FIRE DEPARTMENT.
 - THE BOX MUST BE INSTALLED IN PLAIN VIEW, AS YOU APPROACH THE BUILDING, IN A LOCATION NOT LIKELY TO BE HIDDEN WITH LANDSCAPE GROWTH OR OTHER OBSTRUCTIONS.
 - FOLLOW THE MANUFACTURER'S INSTALLATION INSTRUCTIONS.
 - ALL KEYS MUST BE LABELED USING A SUBSTANTIAL KEY IDENTIFICATION TAG THAT WILL WITHSTAND EXPOSURE TO MOISTURE.
 - TEST ALL KEYS IN LOCK MECHANISMS BEFORE CONTACTING THE FIRE PREVENTION DIVISION.
 - SCHEDULE AN INSPECTION ON THE FIRE PREVENTION DIVISION WEB PAGE TO HAVE THE KEY BOX LOCKED.

CITY OF NAPA

FIRE DEPARTMENT

KNOX BOX MOUNTING HEIGHT

DRAWN BY:	RC	CHECKED BY:	BV
APPROVAL DATE:	08/2021	APPROVED BY:	GDF
SCALE:	NONE	DRAWING NO.	FP-13
REVISED DATE:			

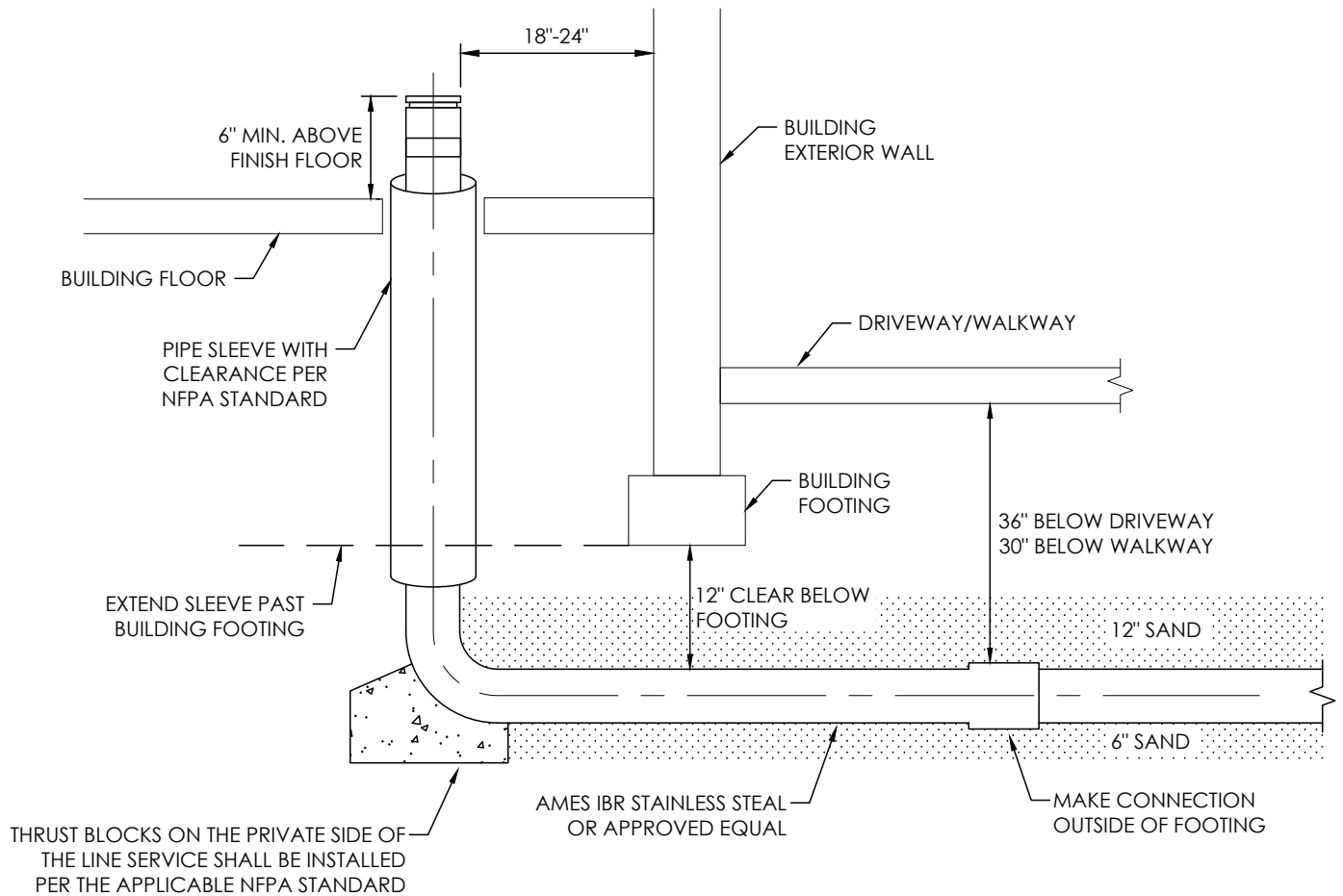

- NOTES:
- CLEARANCE SHALL BE PROVIDED AROUND ALL PIPING EXTENDING THROUGH WALLS, FLOORS, PLATFORMS, AND FOUNDATIONS, INCLUDING DRAINS, FIRE DEPARTMENT CONNECTIONS, AND OTHER AUXILIARY PIPING.
 - CLEARANCE SHALL BE SIZED SUCH THAT THE DIAMETER OF THE HOLES IS NOMINALLY 2" LARGER THAN THE PIPE FOR PIPE 1" (25MM) NOMINAL TO 3 1/2" (90MM) NOMINAL AND 4" (100MM) LARGER THAN THE PIPE FOR PIPE 4" (100MM) NOMINAL AND LARGER.
 - CLEARANCE PROVIDED BY A PIPE SLEEVE, A NOMINAL DIAMETER 2" (50MM) LARGER THAN THE NOMINAL DIAMETER OF THE PIPE SHALL BE ACCEPTABLE FOR PIPE SIZES 1" (25MM) THROUGH 3 1/2" (90MM), AND THE CLEARANCE PROVIDED BY A PIPE SLEEVE OF NOMINAL DIAMETER 4" (100MM) LARGER THAN THE NOMINAL DIAMETER OF THE PIPE SHALL BE ACCEPTABLE FOR PIPE SIZES 4" (100MM) AND LARGER.
 - THE PIPE SLEEVE CLEARANCE SHALL BE FILLED WITH FLEXIBLE MATERIAL THAT IS COMPATIBLE WITH THE PIPING MATERIAL. (ROCK WOOL AND LISTED ELASTOMETRIC OR FLEXIBLE SEALANT. *NO AGGREGATE, SAND, OR ANY OTHER COMPACTED MATERIAL ALLOWED.

CITY OF NAPA

FIRE DEPARTMENT

FIRE SERVICE UNDERGROUND
INSTALLATION DETAIL

DRAWN BY: RC
 APPROVAL DATE: 08/2021
 SCALE: NONE
 REVISED DATE:

CHECKED BY: BV
 APPROVED BY: GDF
 DRAWING NO. FP-14

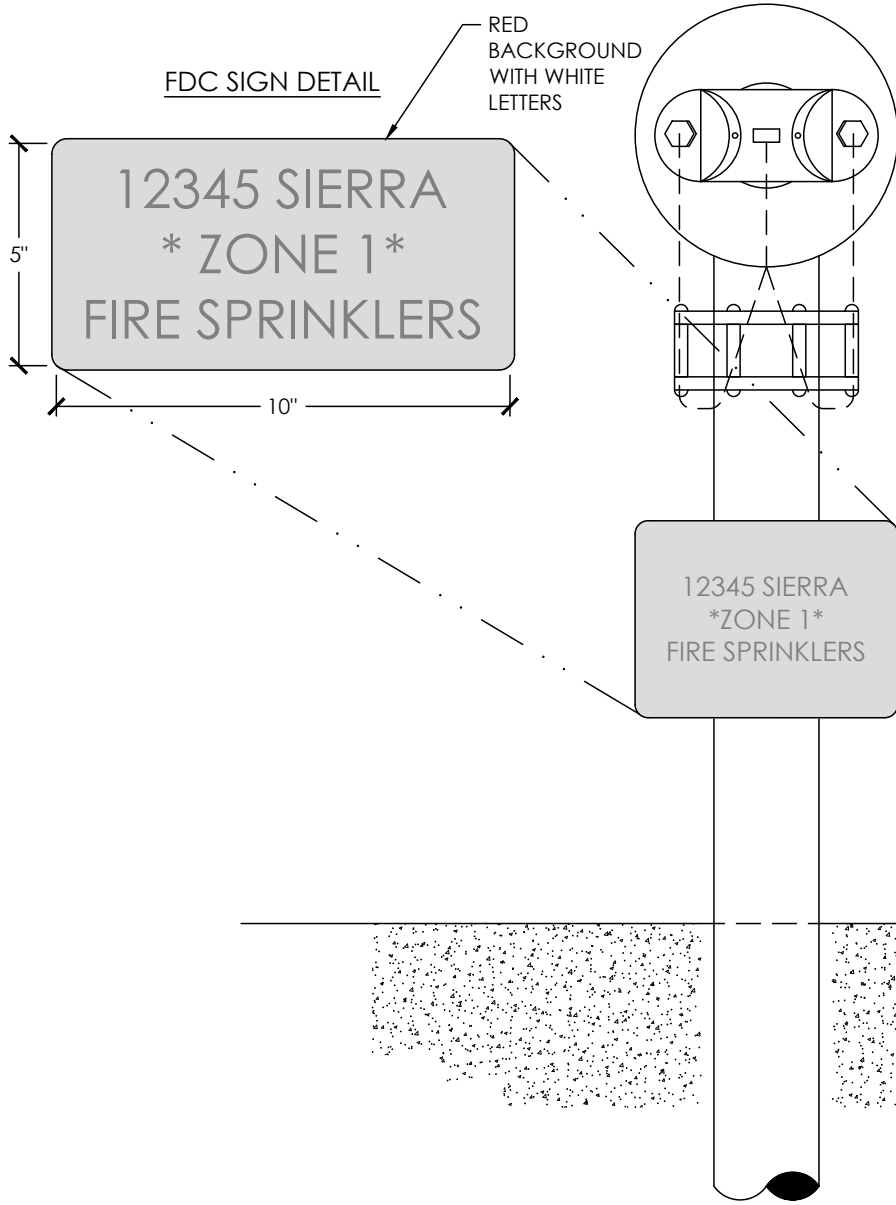

FDC SIGN ATTACHMENT

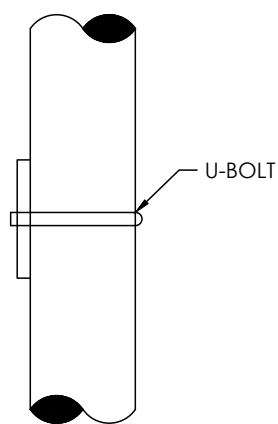

CITY OF NAPA FIRE DEPARTMENT

FDC IDENTIFICATION SIGNAGE DETAIL

DRAWN BY:	RC	CHECKED BY:	BV
APPROVAL DATE:	08/2021	APPROVED BY:	GDF
SCALE:	NONE	DRAWING NO.	FP-15
REVISED DATE:			

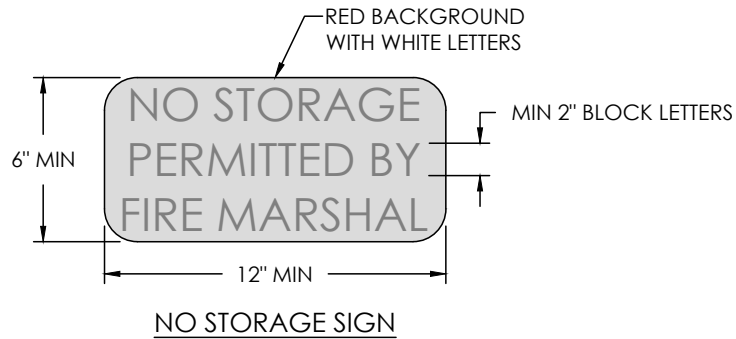
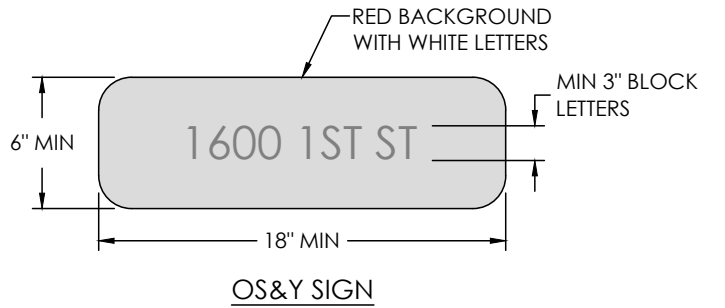
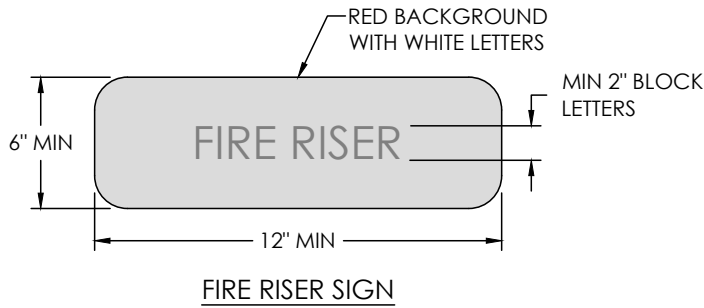
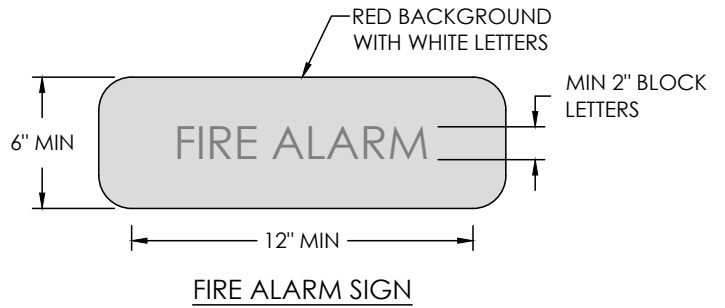
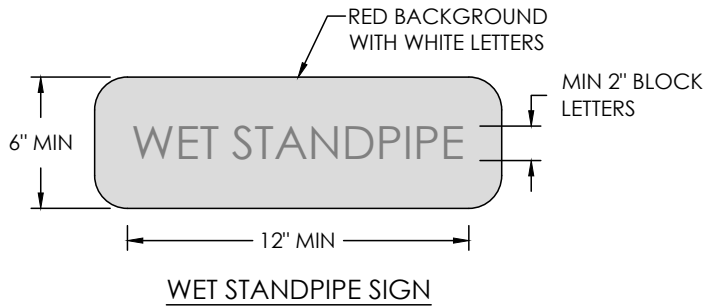
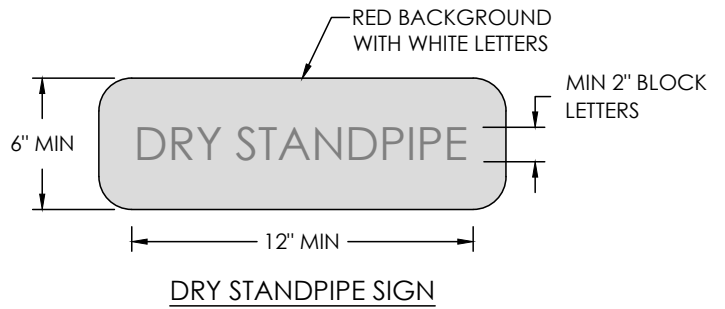
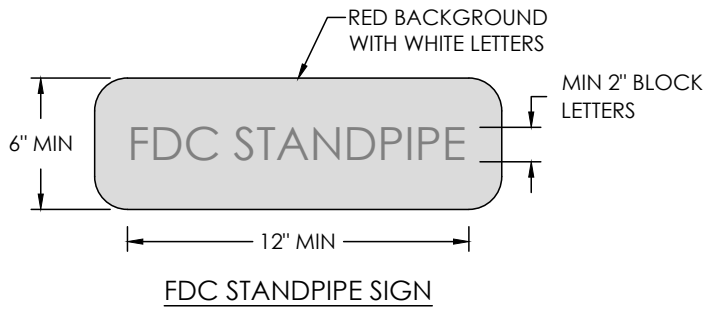

NOTES:

1. ALL UTILITY ROOMS AND RELATED FIRE APPURTENANCES SHALL BE LABELED AND BE PROPERLY IDENTIFIED AS TO THE PURPOSE THEY SERVE.
2. SIGNAGE AT HVAC, SPRINKLER, ELECTRICAL, AND FIRE ALARM CONTROL PANEL LOCATION.
3. ALL REQUIRED SIGNS SHALL BE WEATHER RESISTANT AND PERMANENTLY AFFIXED.
4. IN UTILITY ROOMS OR OTHER AREAS WHERE COMBUSTIBLE STORAGE IS NOT ALLOWED, A PERMANENTLY AFFIXED SIGN SHALL BE INSTALLED THAT READS, "NO STORAGE PERMITTED BY ORDER OF FIRE MARSHAL".

CITY OF NAPA

FIRE DEPARTMENT

SIGNAGE DETAILS

DRAWN BY:	RC	CHECKED BY:	BV
APPROVAL DATE:	08/2021	APPROVED BY:	GDF
SCALE:	NONE	DRAWING NO.	FP-16
REVISED DATE:			

INTENTIONALLY LEFT BLANK